

IMPORTANT

WRONG

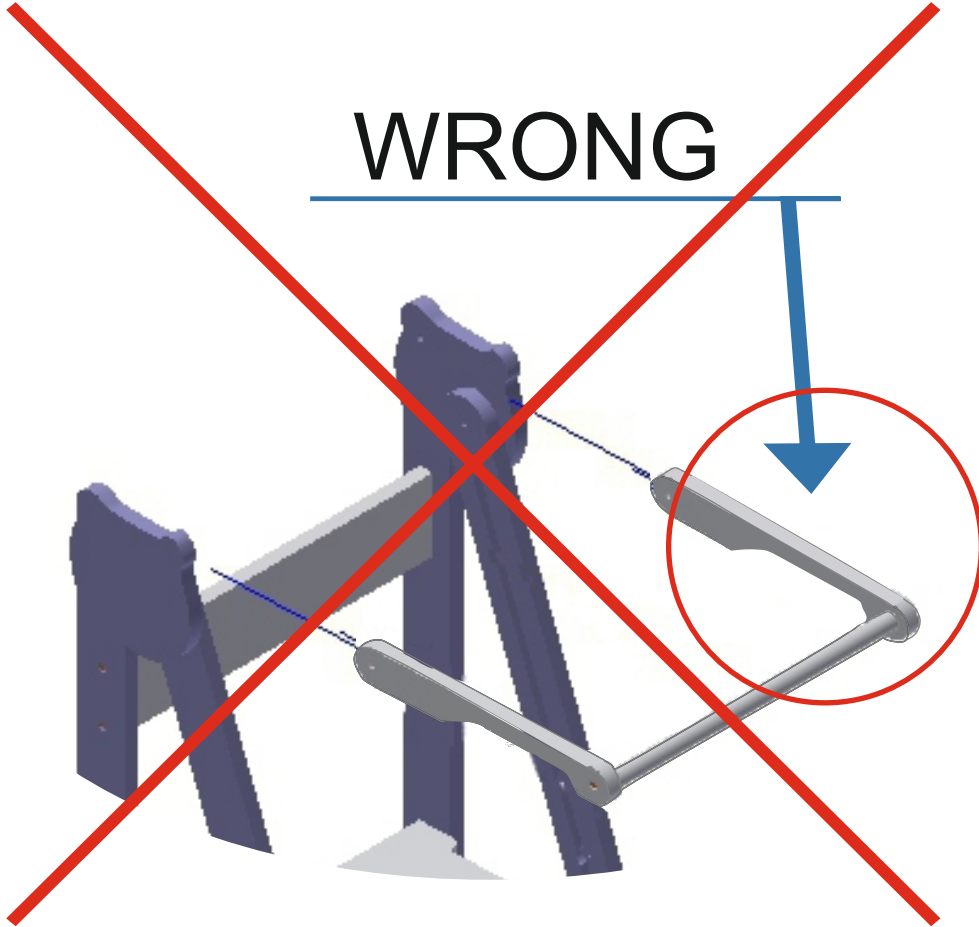

CORRECTLY

Before safety bar installation, please make sure that

DETAILS RECESS IS LOOKING UP

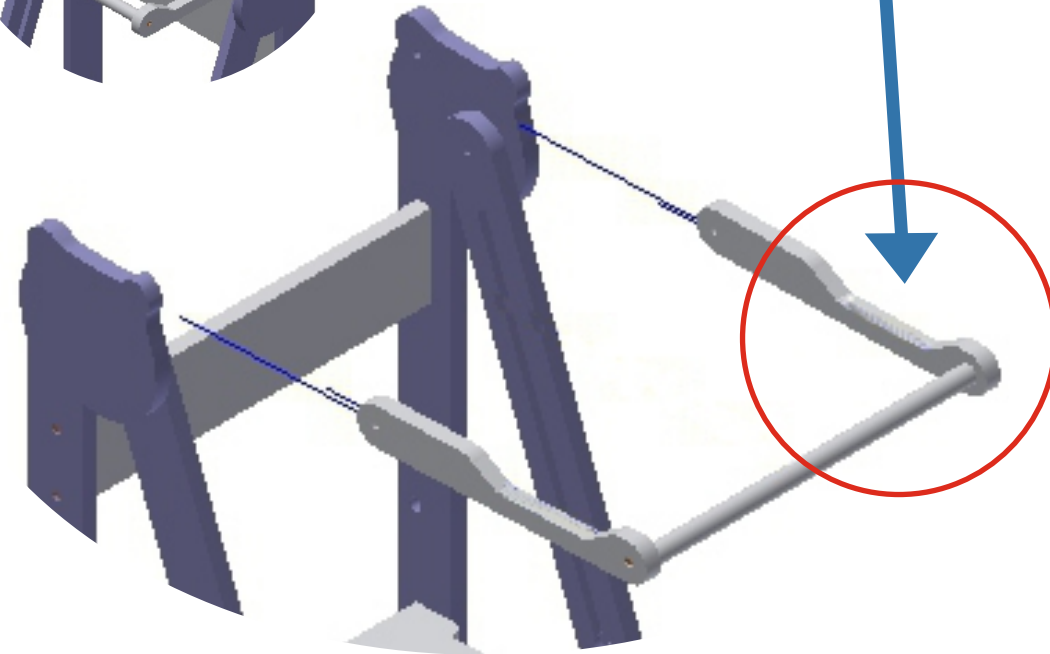
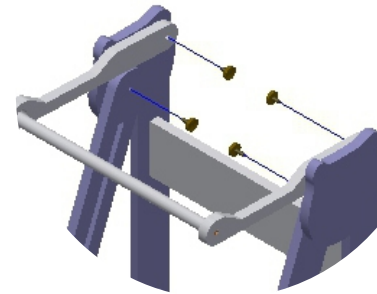

Ensure all screws and hardware are tightened and locked into place before use.
Improper assembly of the chair can damage the furniture, in case of damage the warranty is void.



VIDEO ASSEMBLY
INSTRUCTION