

# MONTAGEANLEITUNG

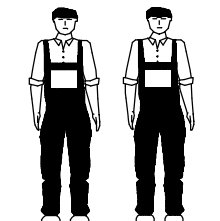

2 Pers. t= 20min

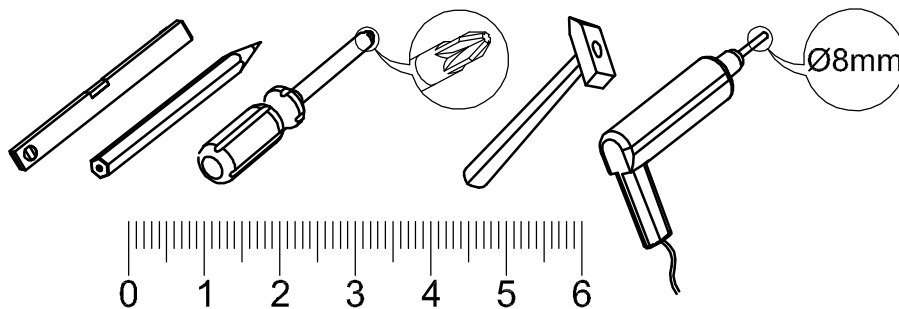

## WANDBOARD (COX1QT50)

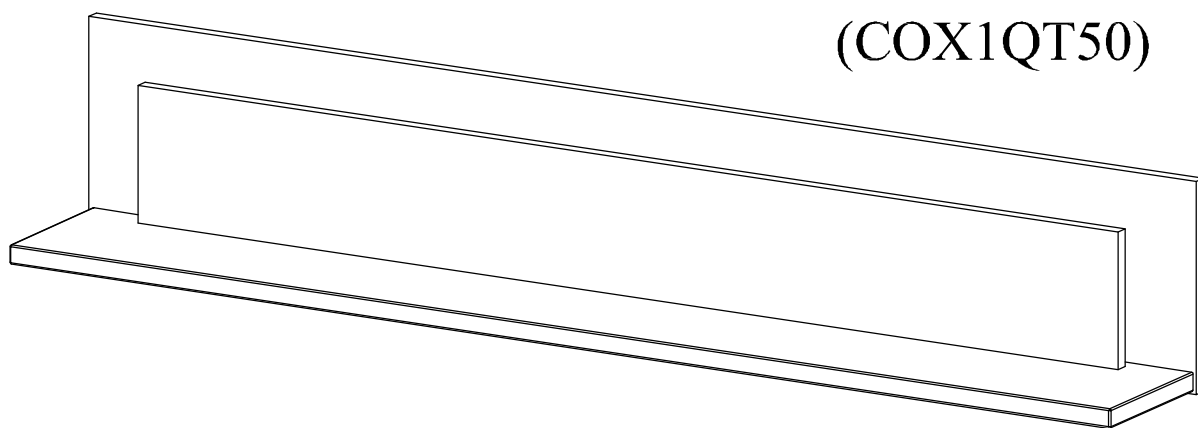

## PACKSTUCK INHALT

COLLI 1/1	
A	1390 x 240 x 18
B	1150 x 115 x 16
C	1230 x 155 x 16
D	1382 x 180 x 22

## BESCHLÄGLISTE

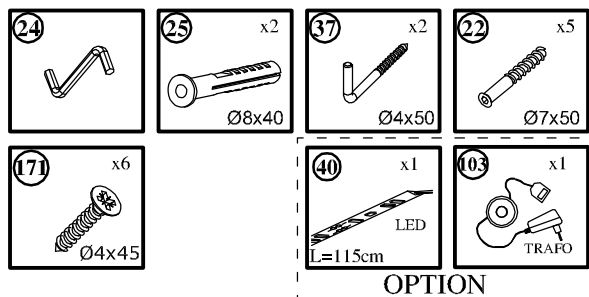

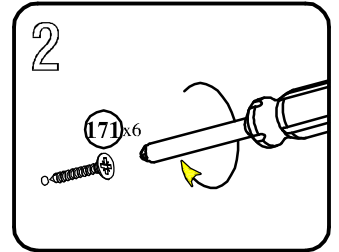
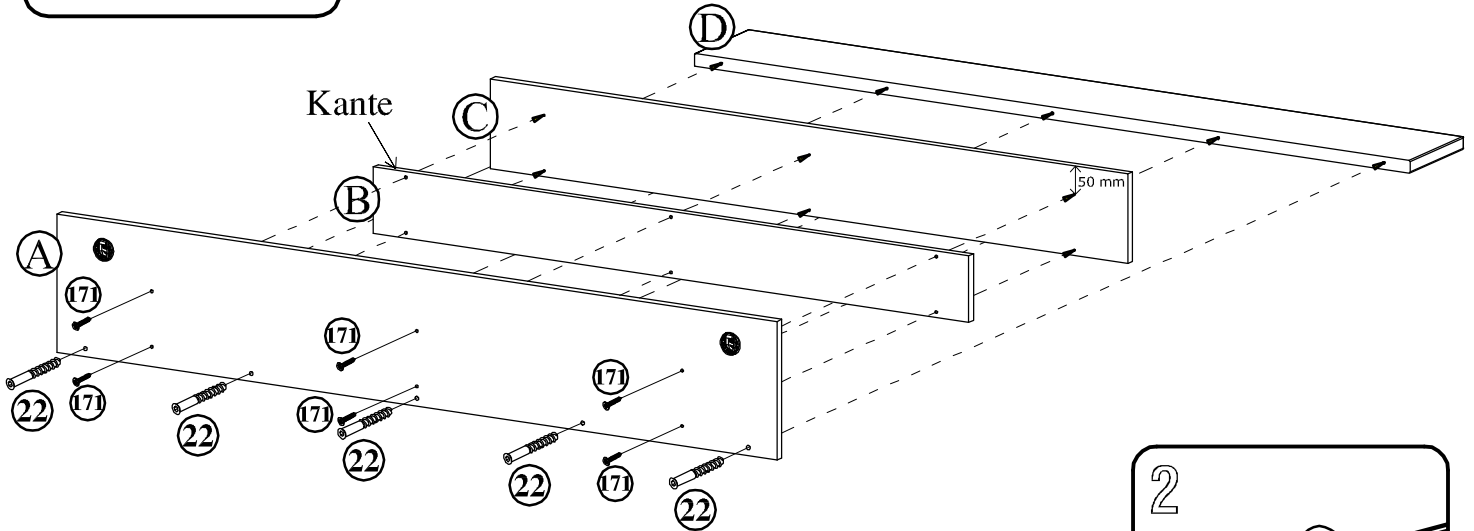
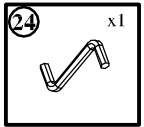
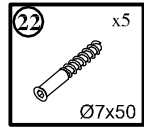
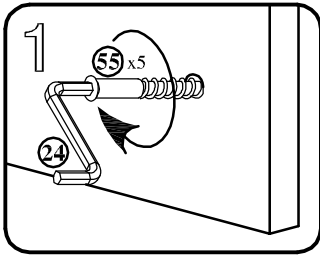

## OPTION

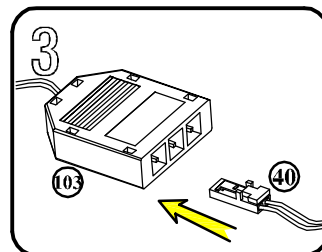
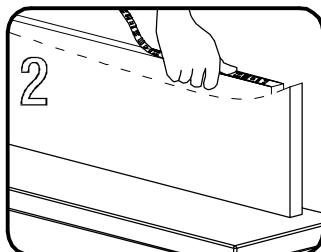
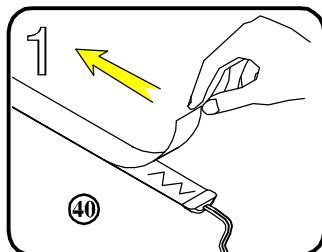
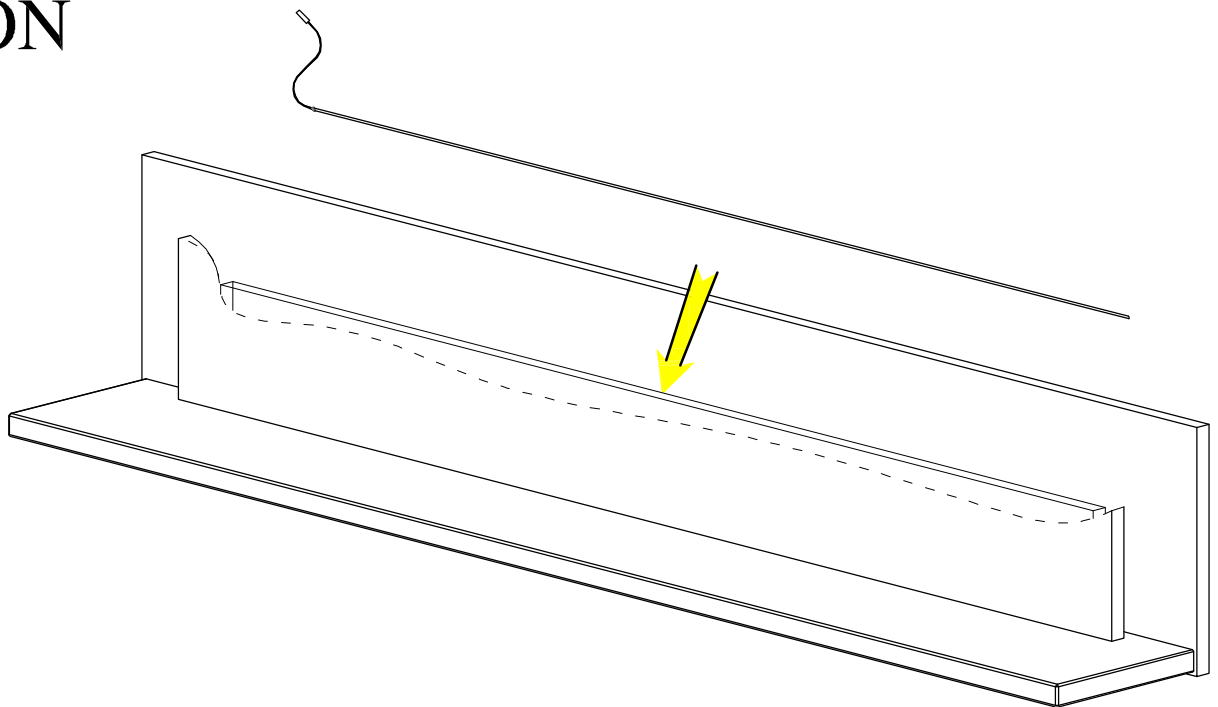
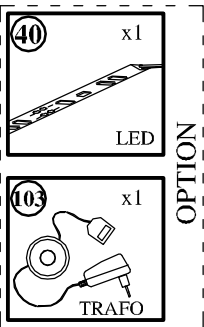

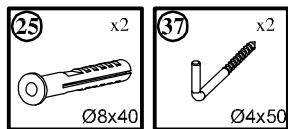

**! ACHTUNG !**  
**MAX . BELASTUNG**  
**DER BODEN 3 kg**

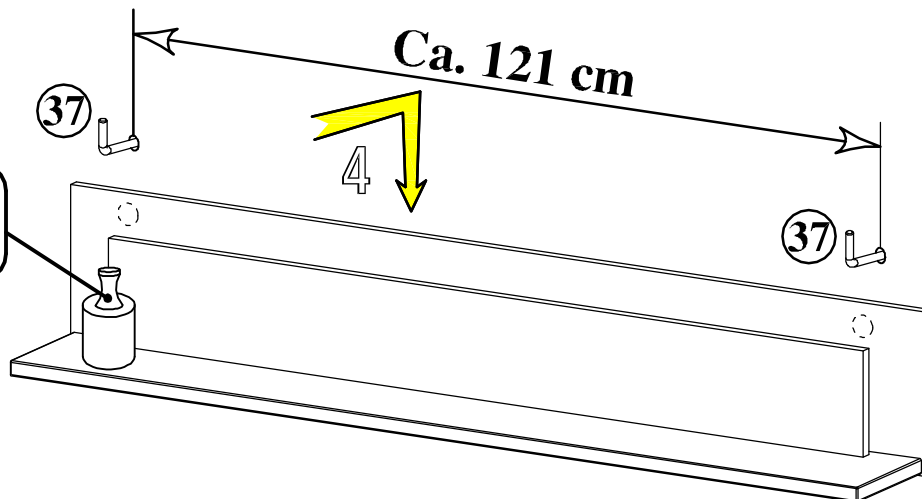

Die beigefügten Dübel zum Aufhängen des Elements dürfen nur bei Betonwänden eingesetzt werden, bei anderen Wandarten müssen entsprechende Dübel zugekauft werden.

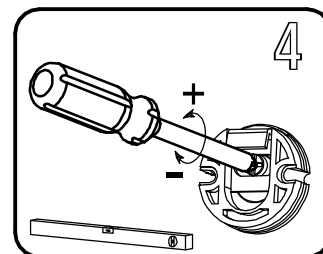
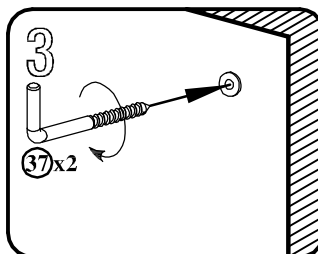
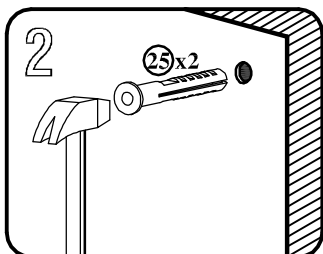
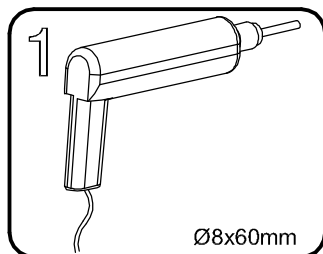

Ca. 19,8 cm

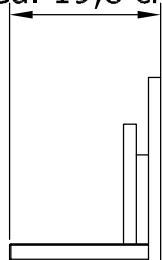

Ca. 139,0 cm

