

# MONTAGEANLEITUNG

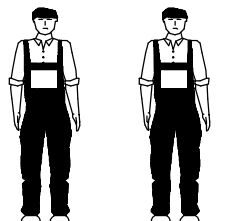

2 Pers. t= 45min

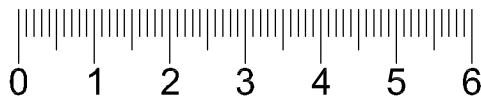
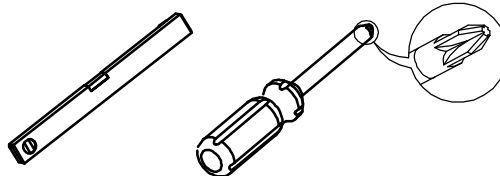

## COUCHTISCH (COX1QT65)

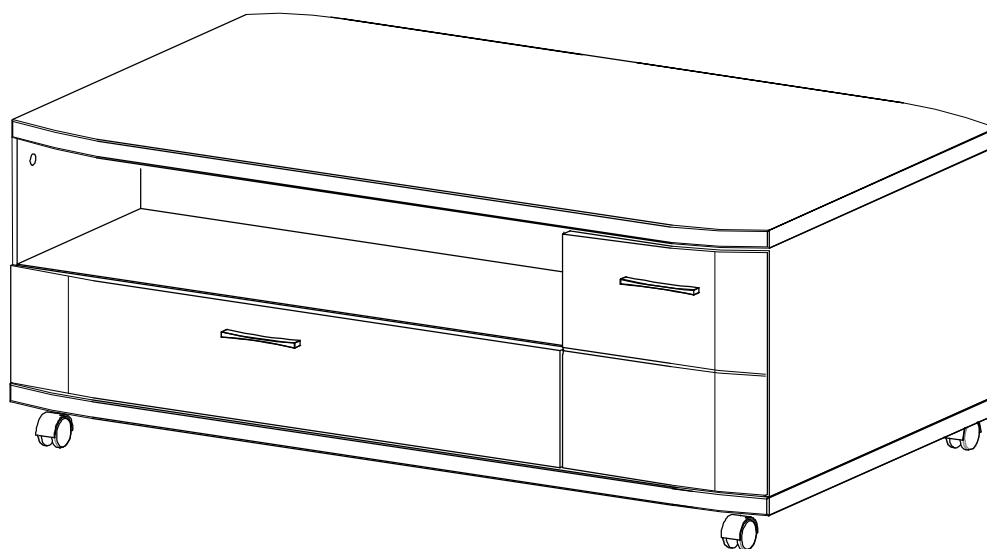

## BESCHLÄGLISTE

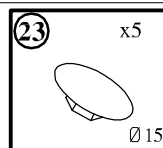
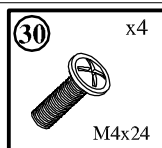
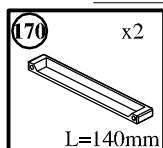
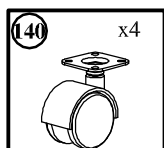

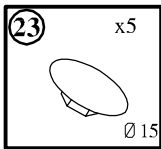
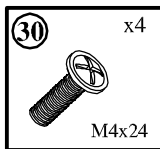
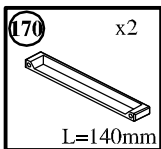
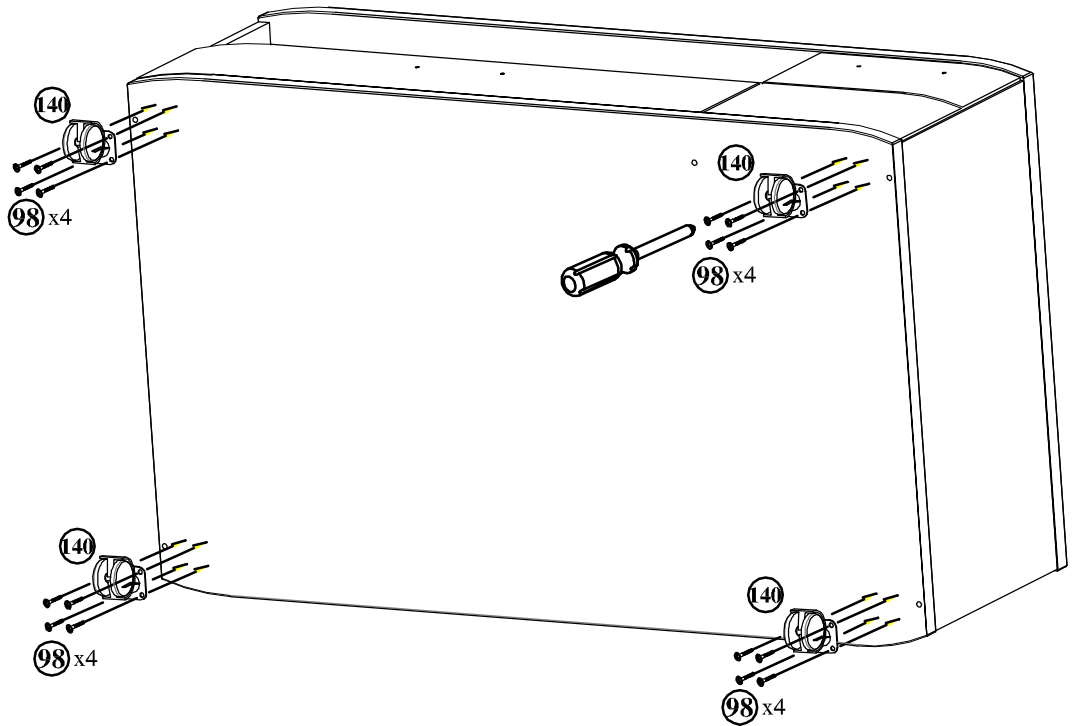
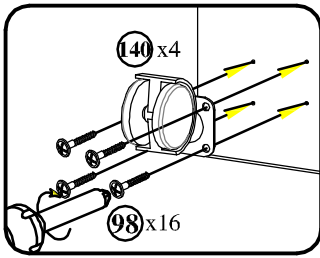
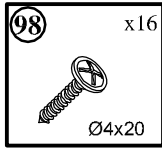
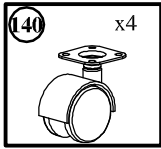

**! ACHTUNG !**  
MAX . BELASTUNG 30 kg

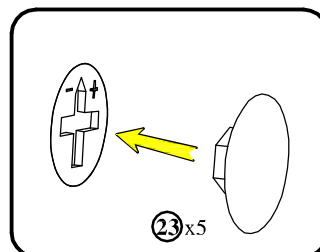
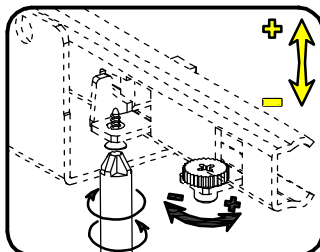
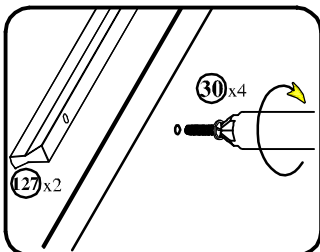
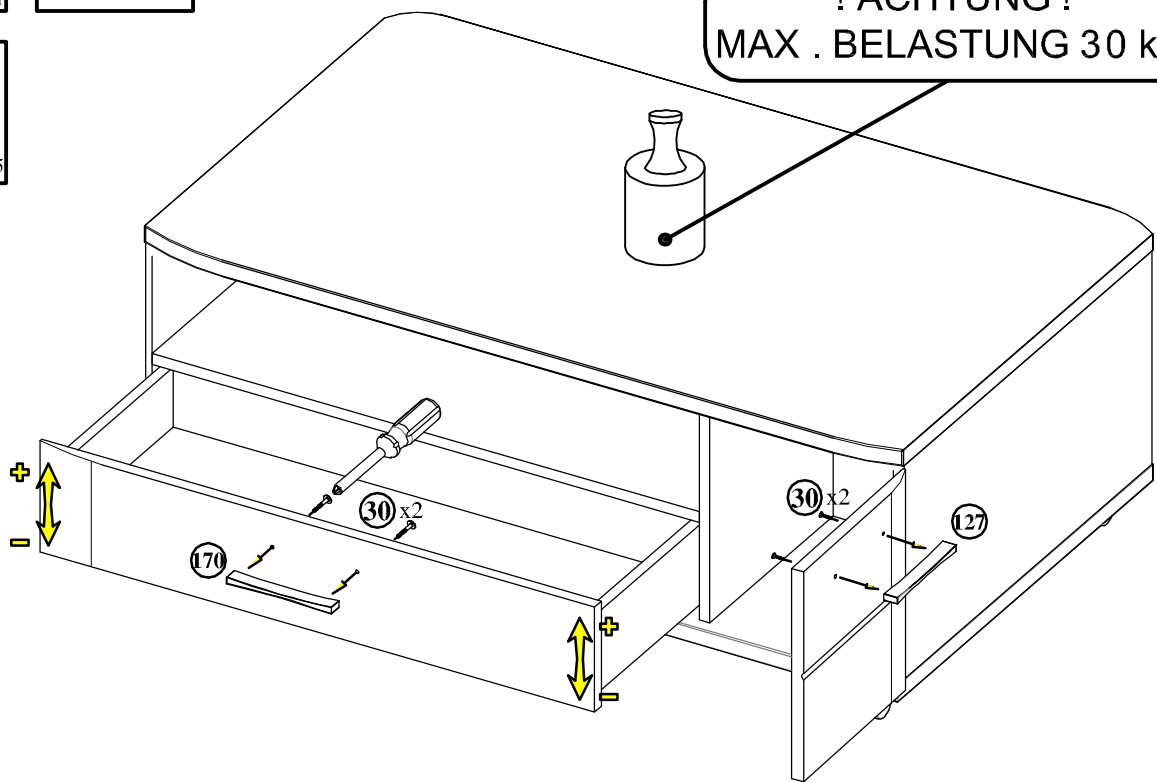

**Pflegehinweis !**

Bitte nur mit einem Staubtuch oder einem feuchten Lappen reinigen.

**KEINE** scheuernde Putzmittel verwenden !

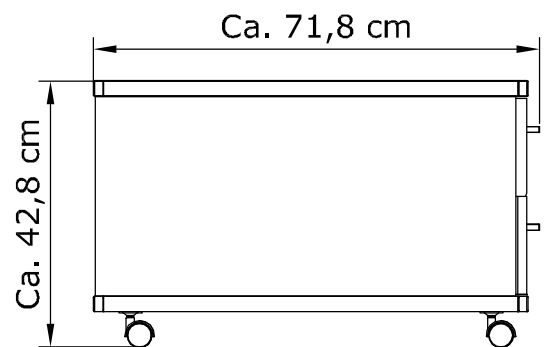
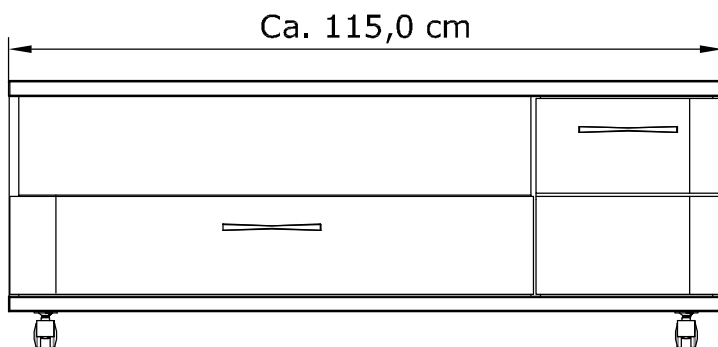

## a) **Fugenverstellung:**

Befestigungsschraube "A" lockern, gewünschte Fuge mit Schraube "B" einstellen. Schraube "A" anziehen.

## Verstellmöglichkeiten

b) **Tiefenverstellung:**  
Befestigungsschraube "A" lockern, Bandarm nach voren oder ruckwärts verschieben, Schraube "A" anziehen, Schraube "B" mit einer 1/4 Drehung nach rechts arretieren.

c) **Hohenverstellung:**  
Befestigungsschraube "C" lockern, Höhe einstellen, Schraube "C" anziehen.

