

<b>2X</b> 	<b>25 MIN</b> 					
MODEL <b>"MM249/DRIFT"</b>						

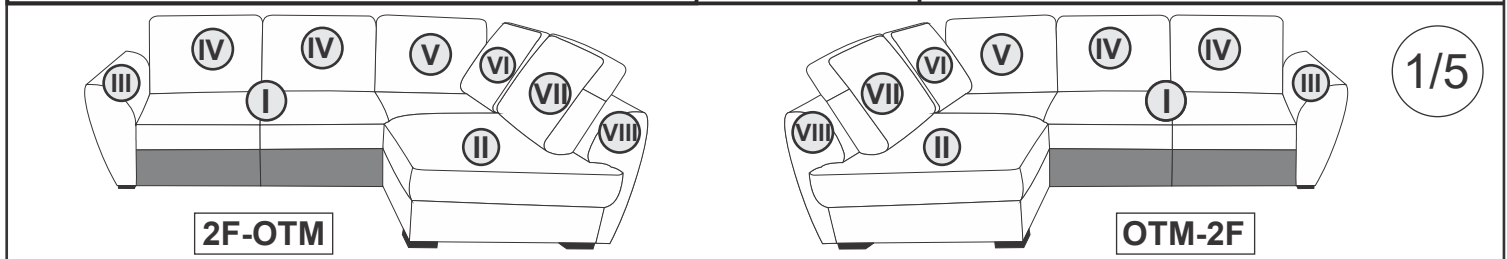

- |   |                    |                |                |                       |   |                     |                      |                      |                |                |
|---|--------------------|----------------|----------------|-----------------------|---|---------------------|----------------------|----------------------|----------------|----------------|
| <b>H</b><br>x1  | <b>I</b><br>6MM x1 | <b>D</b><br>x3 | <b>F</b><br>x3 | <b>K</b> M8X100<br>x3 | <b>A</b> CORDOBA H45<br>x4  | <b>B</b> 6X50<br>x4 | <b>C</b> LG 45<br>x2 | <b>E</b> M8X60<br>x3 | <b>F</b><br>x3 | <b>G</b><br>2x |
| hardware bag/sachet materiel/zubehorbeutel/sachetti materiale/bolsa de materiales/worek materialowy |                    |                |                |                       | pre-assembled/ pre assemble/vormontiert/premontato/wstepnie/zamontowane |                     |                      |                      |                |                |

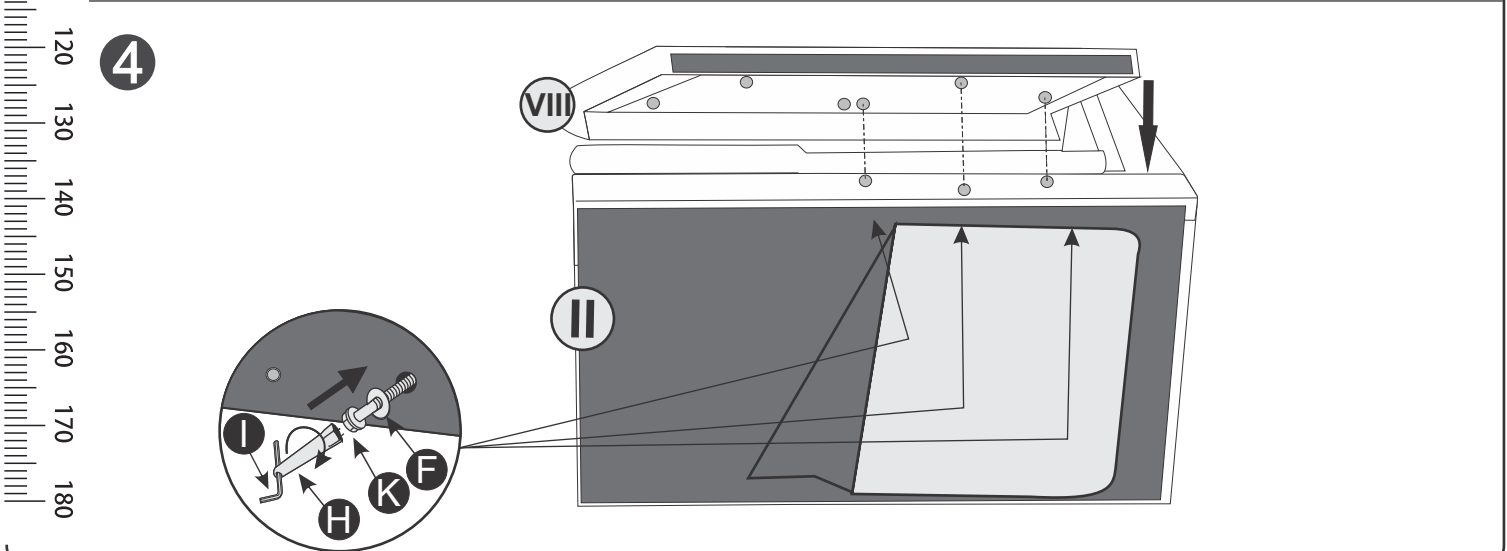
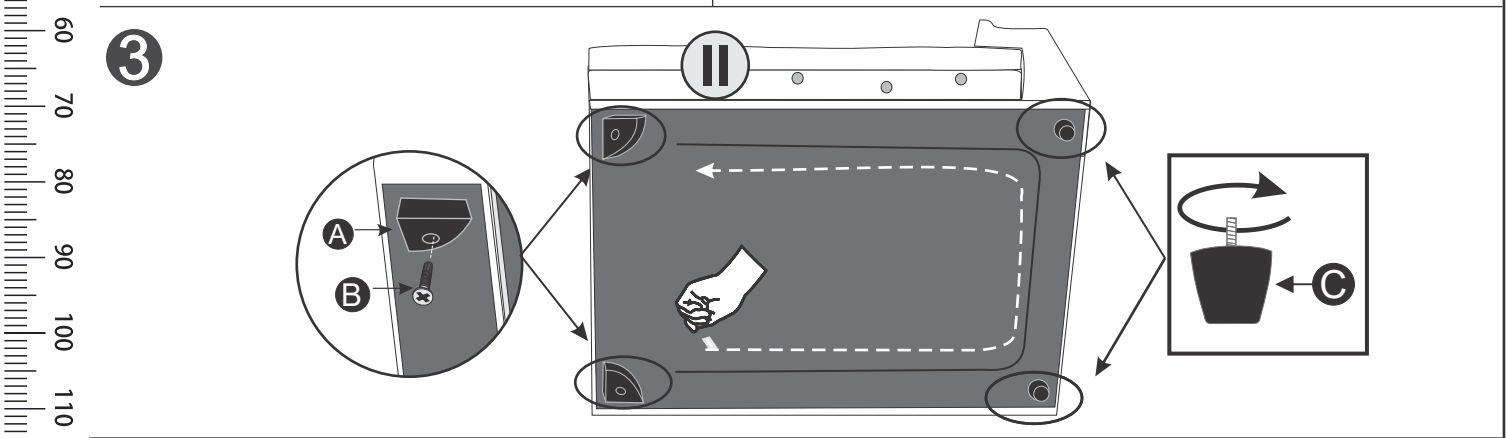
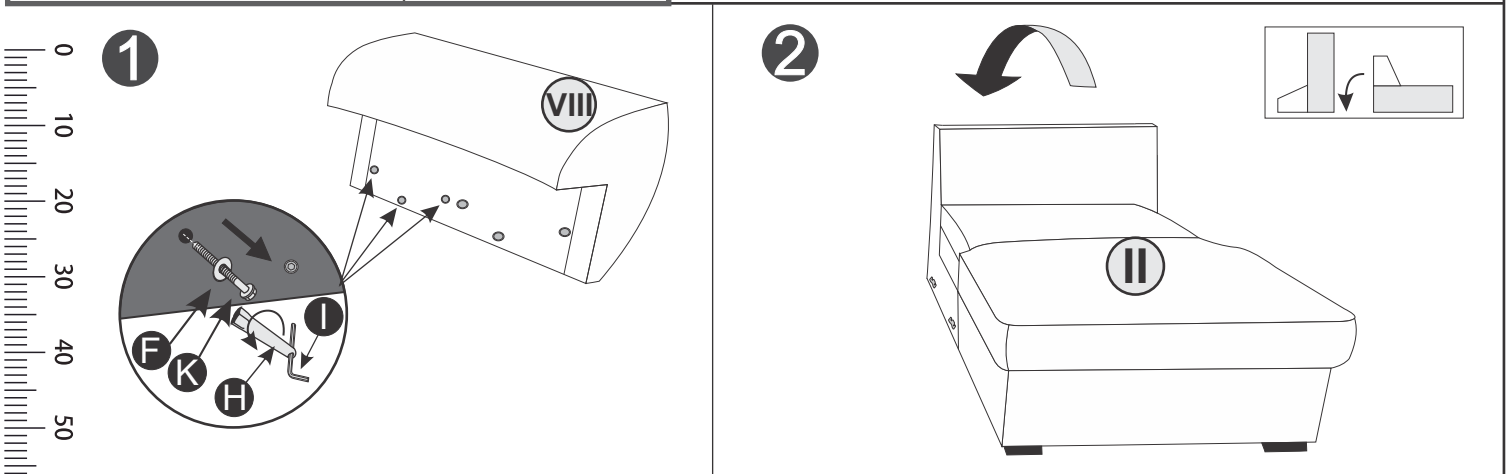

0  
10  
20  
30  
40  
50  
60  
70  
80  
90  
100  
110  
120  
130  
140  
150  
160  
170  
180

2X

25 MIN

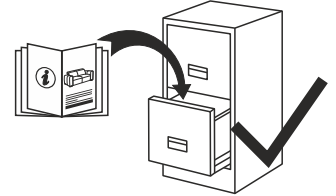
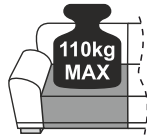
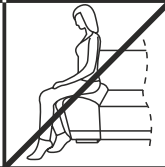

MODEL "MM249/DRIFT"

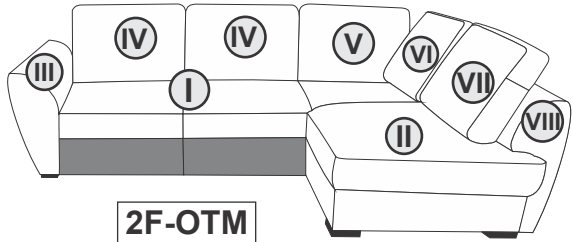

2F-OTM

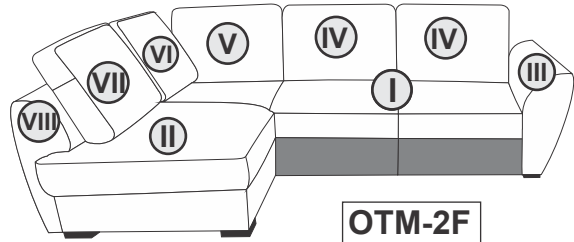

OTM-2F

2/5

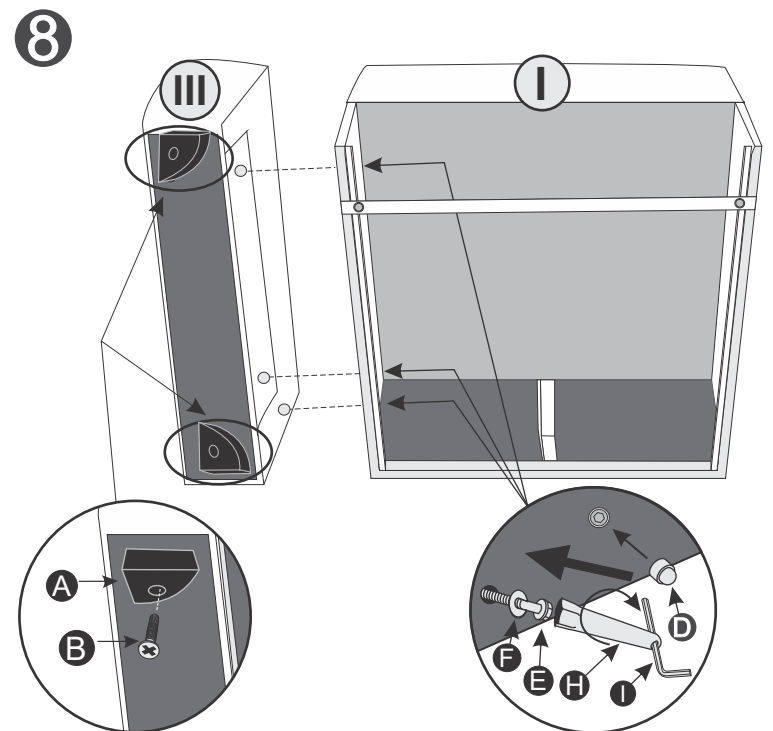
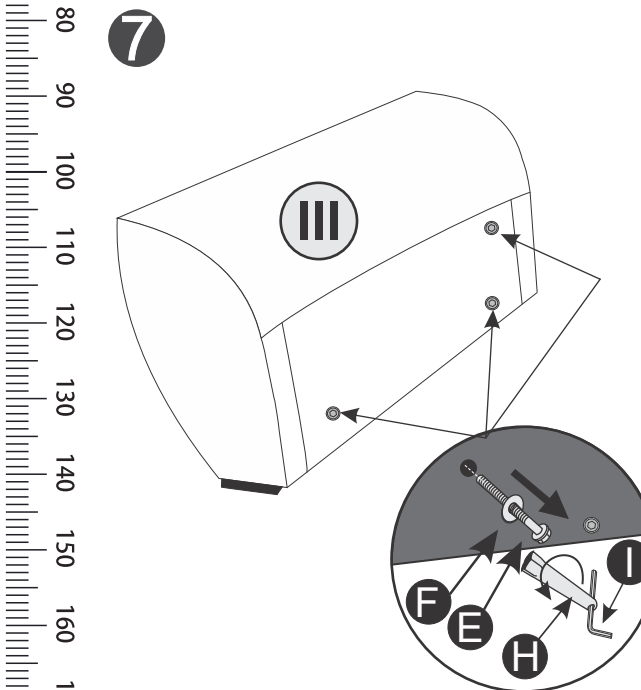
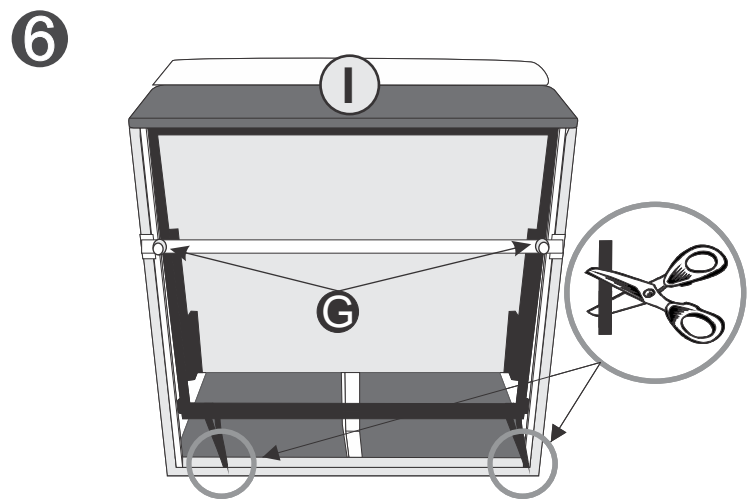
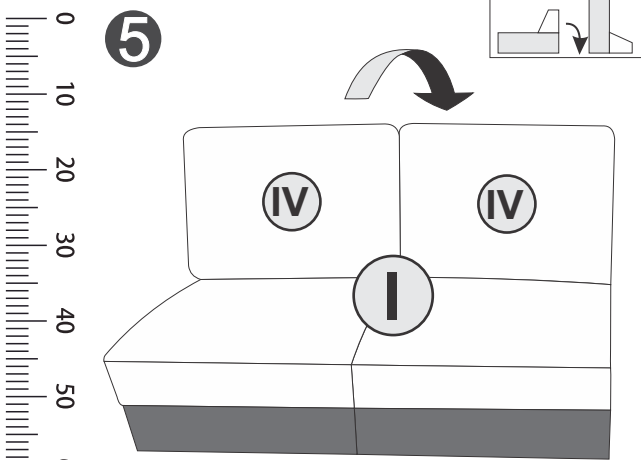
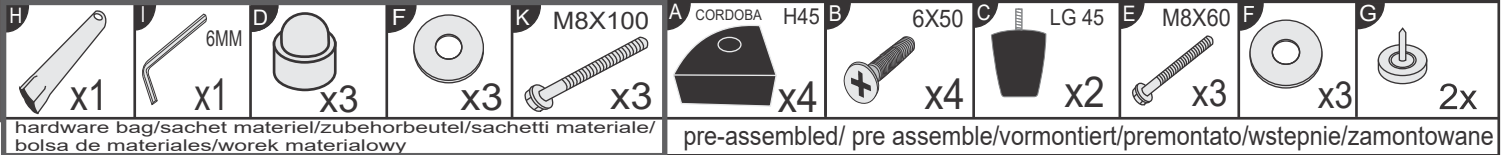

2X

25 MIN

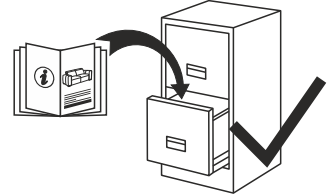
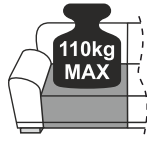

MODEL "MM249/DRIFT"

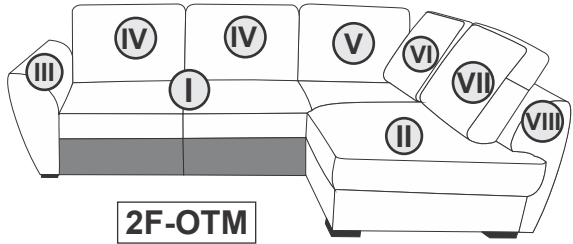

2F-OTM

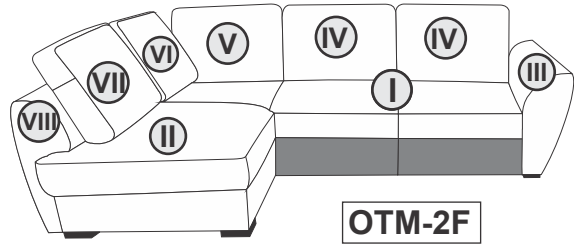

OTM-2F

3/5

9

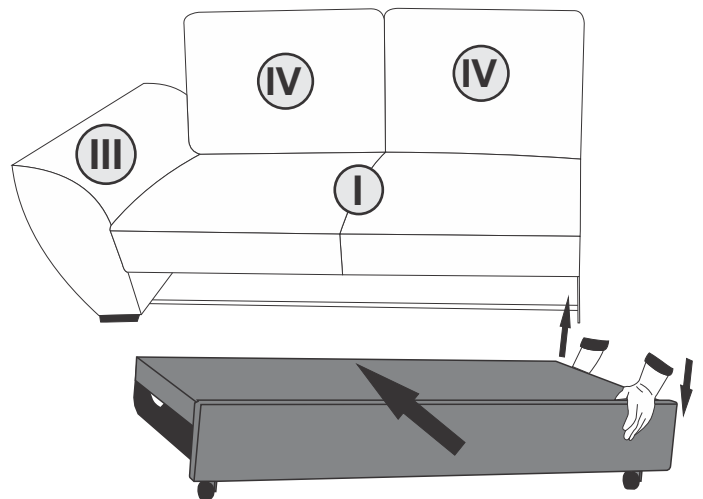
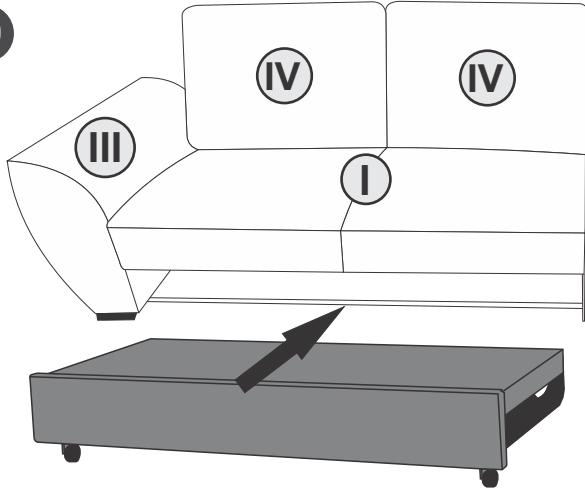

10

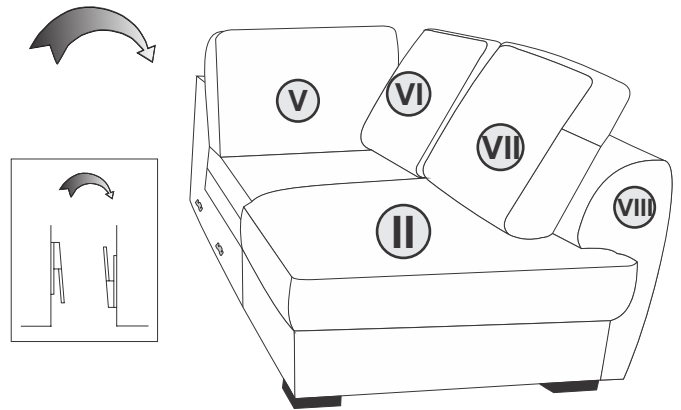
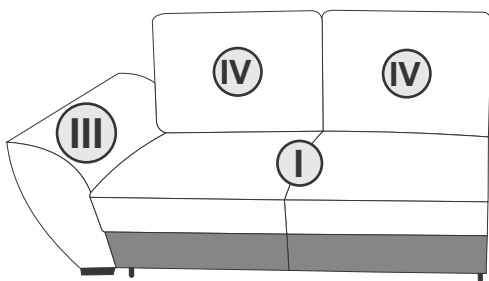

11

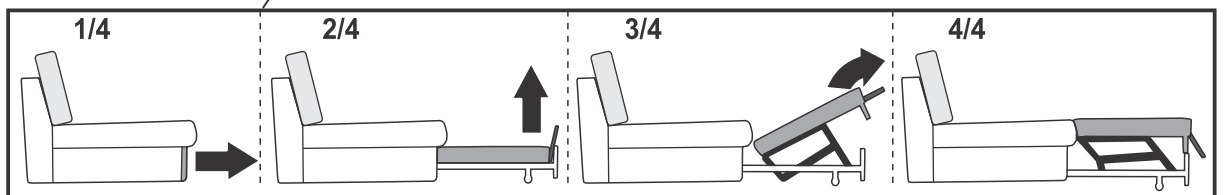
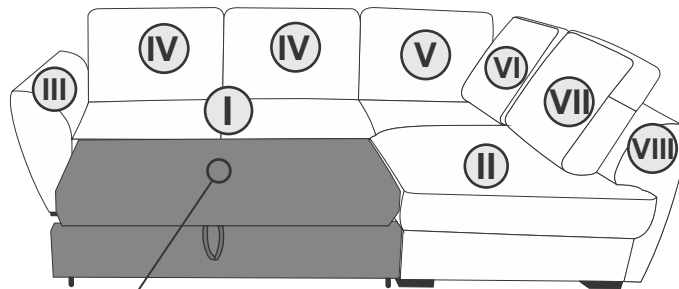

2X

25 MIN

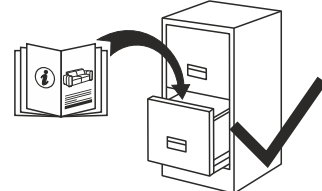
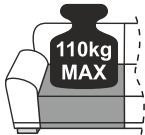

MODEL "MM249/DRIFT"

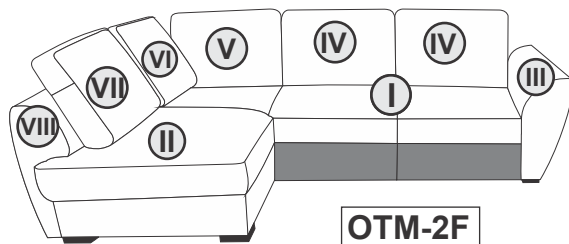
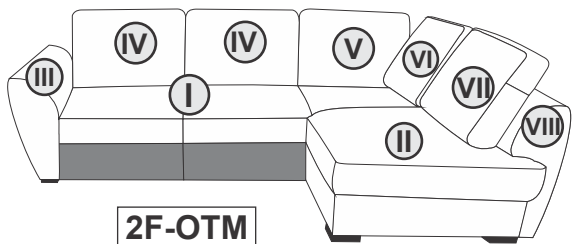

4/5

12

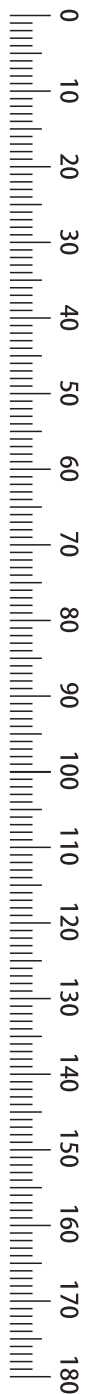
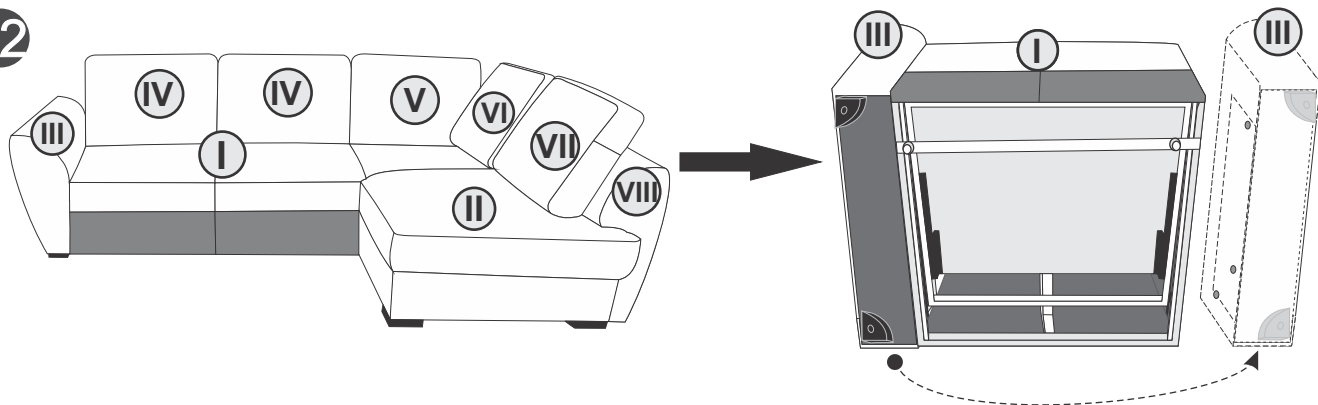

13

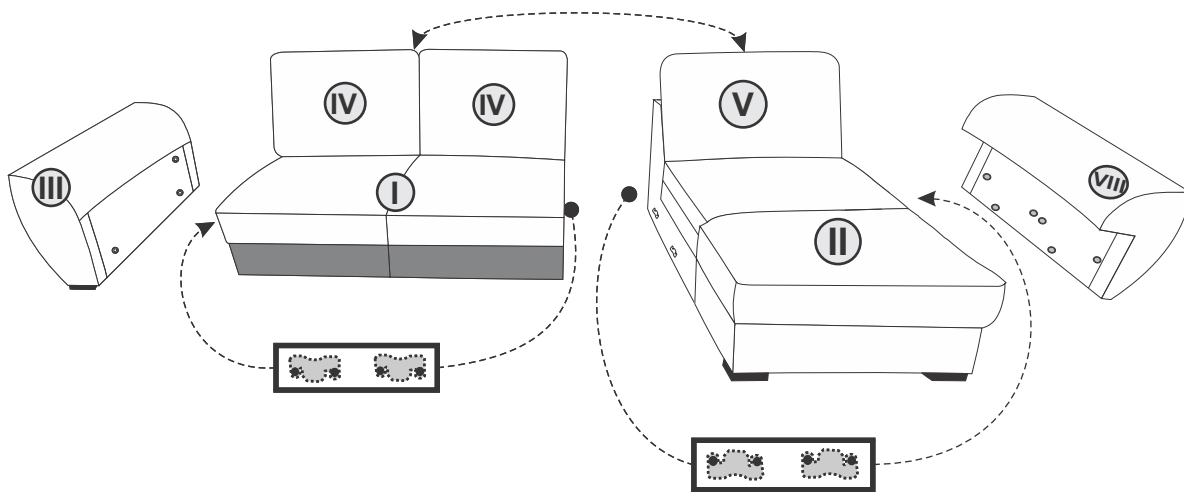

14

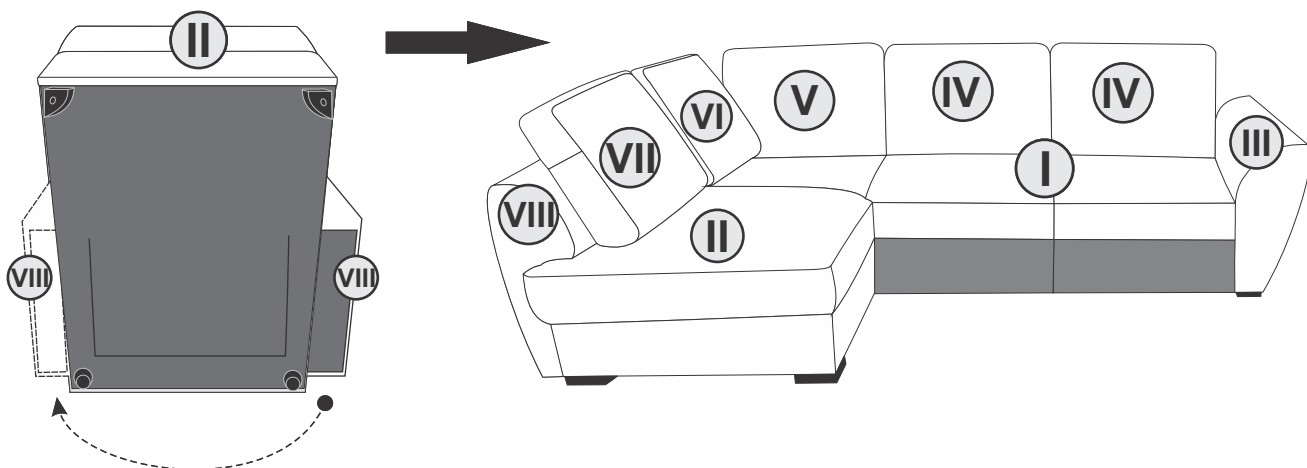

2X

25 MIN

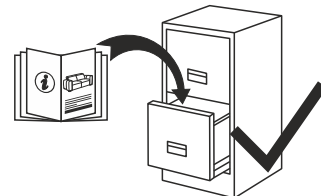
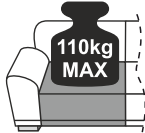
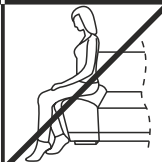

MODEL "MM249/DRIFT"

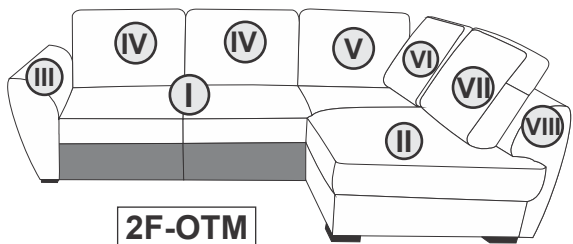

2F-OTM

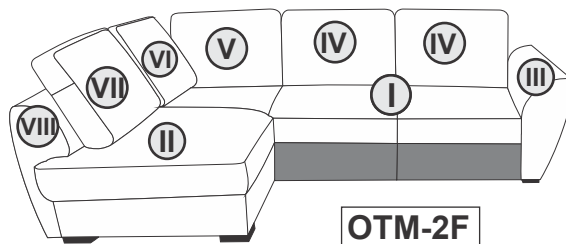

OTM-2F

5/5

15

