

REPC-Nr.:

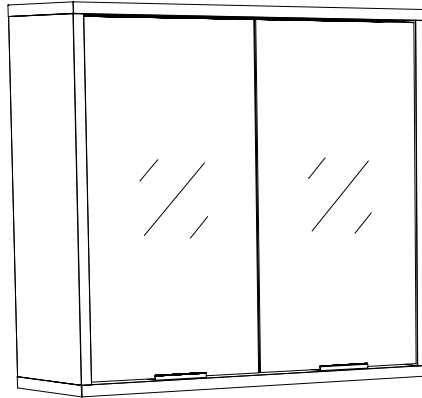

Artikel.-Nr.:

**1000-SPS-2**

Montageanleitung.-Nr.:

**MA1-00534**

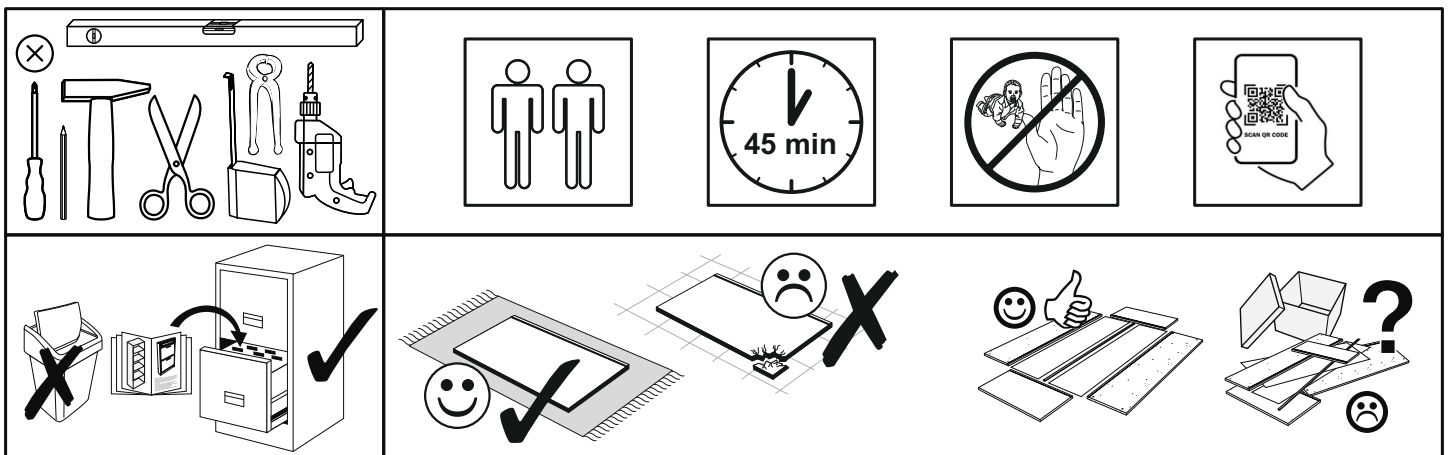

SCAN ME

Das Ersatzteil-Anforderungsformular finden Sie auf  
The replacement parts requisition form you find on  
<https://www.maeusbacher.de/ersatzteile/>

## BT1-00635 Colli 1/1

|                   |          |                   |                  |        |                   |      |                   |
|-------------------|----------|-------------------|------------------|--------|-------------------|------|-------------------|
| B01-200<br>4x<br> | 6,3x13   | B01-244<br>1x<br> | B01-80<br>8x<br> | 3,5x13 | B02-103<br>4x<br> | 8x30 | B02-160<br>8x<br> |
| B02-10<br>8x<br>  | ø15x12mm | B02-20<br>8x<br>  | B08-40<br>2x<br> | 5,8x65 | B08-70<br>2x<br>  | ø8mm | B01-90<br>4x<br>  |



▶ SCAN ME

## BT1-00230 Colli 1/1

|                  |                  |                  |
|------------------|------------------|------------------|
| B03-43<br>4x<br> | B03-11<br>4x<br> | B03-07<br>2x<br> |
|------------------|------------------|------------------|

## BT1-00636 Colli 1/1

|                   |                  |                   |
|-------------------|------------------|-------------------|
| B06-425<br>2x<br> | B05-02<br>8x<br> | B05-185<br>4x<br> |
|-------------------|------------------|-------------------|

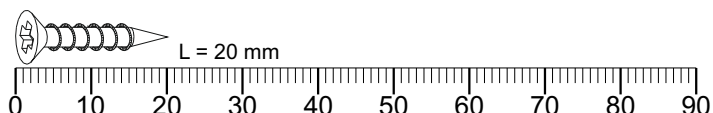

## Colli 1/1

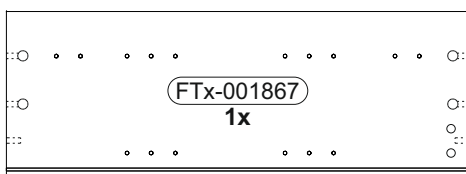

612 x 224

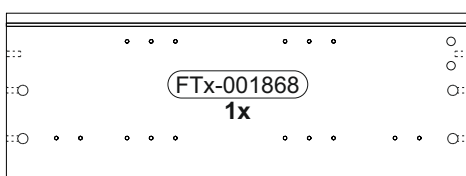

612 x 224

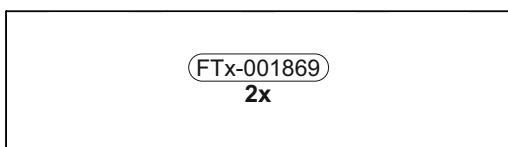

668 x 185

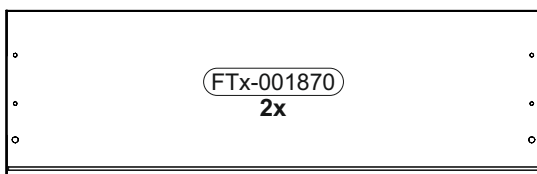

707 x 224

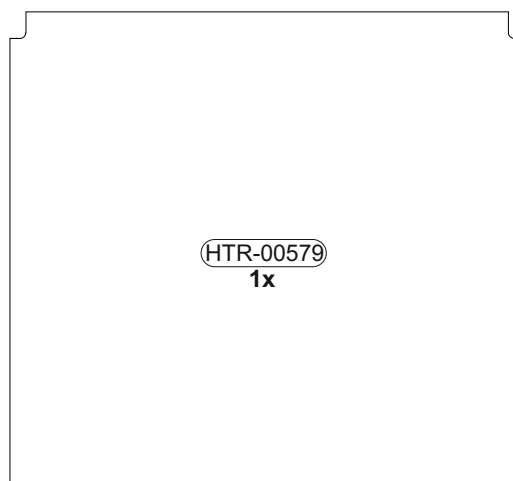
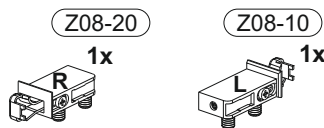

624 x 680

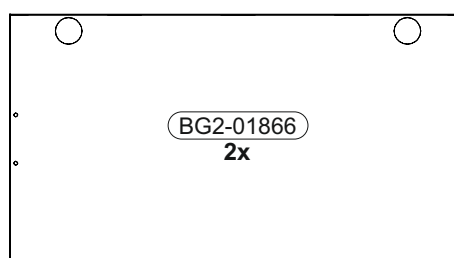

604 x 330

**1**

|        |  |
|--------|--|
| B02-20 |  |
| 8x     |  |

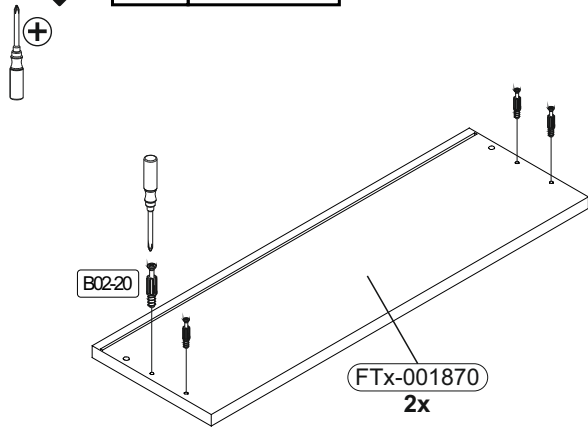

**2**

|        |        |        |  |
|--------|--------|--------|--|
| B01-80 |        | B03-43 |  |
| 8x     | 3,5x13 | 4x     |  |

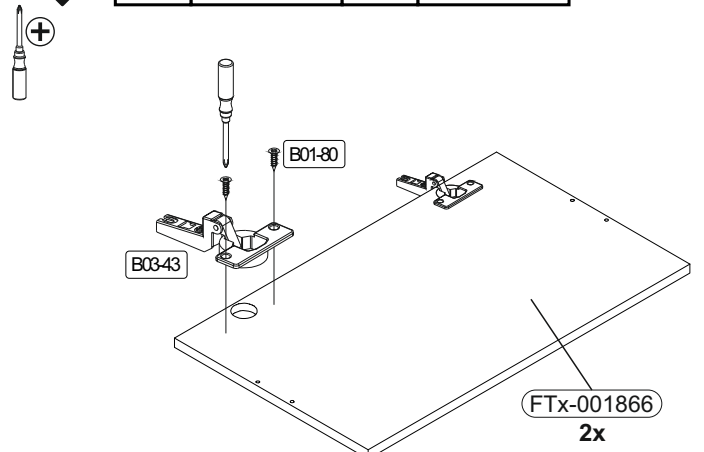

**3**

|        |          |         |  |  |         |      |        |  |
|--------|----------|---------|--|--|---------|------|--------|--|
| B02-10 |          | B02-160 |  |  | B02-103 |      | B03-11 |  |
| 8x     | ø15x12mm | 8x      |  |  | 4x      | 8x30 | 4x     |  |

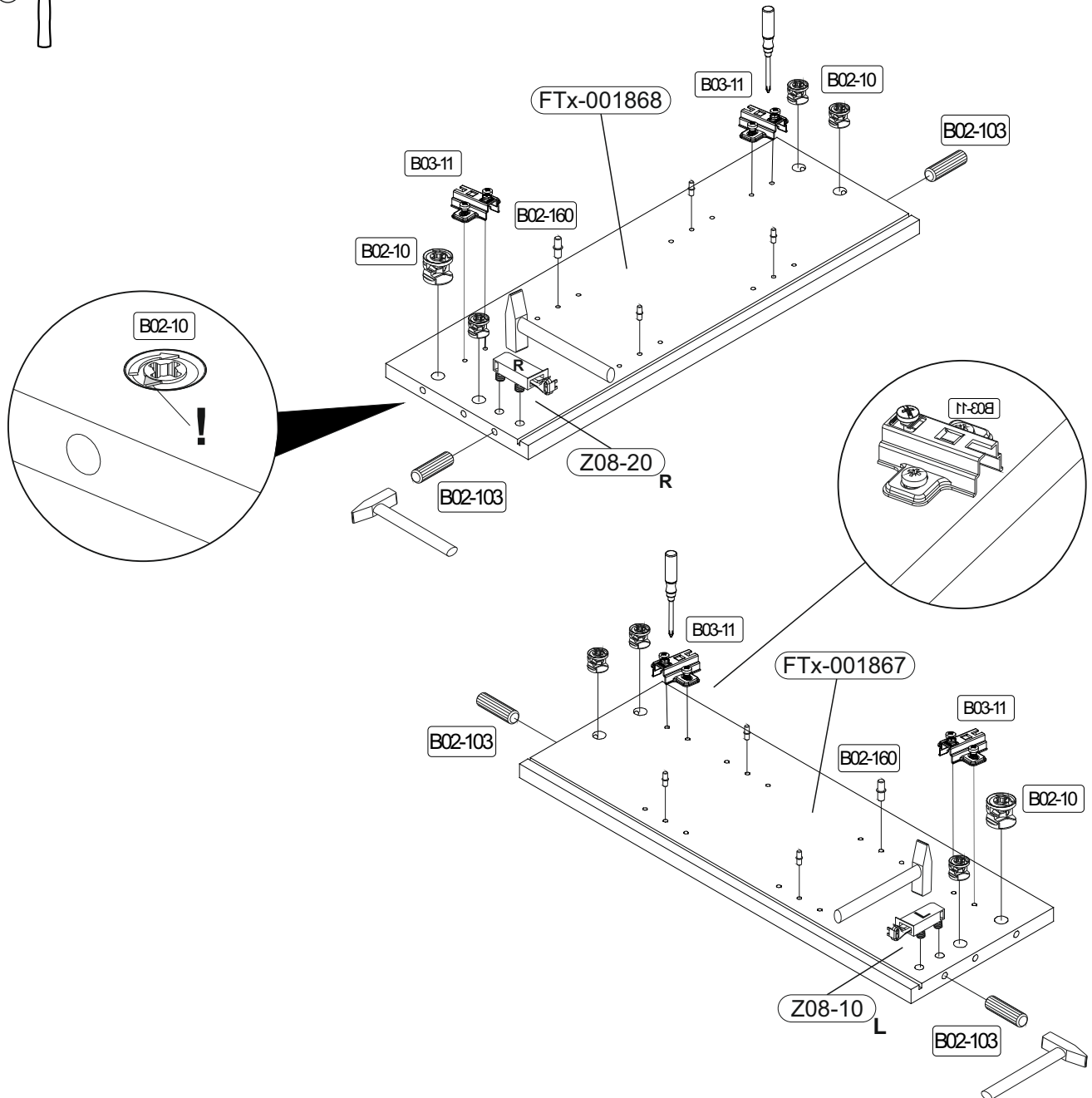
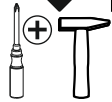

4

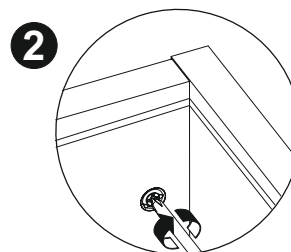
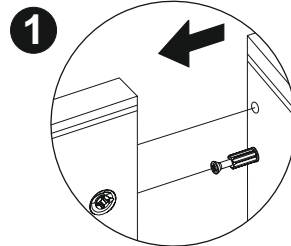
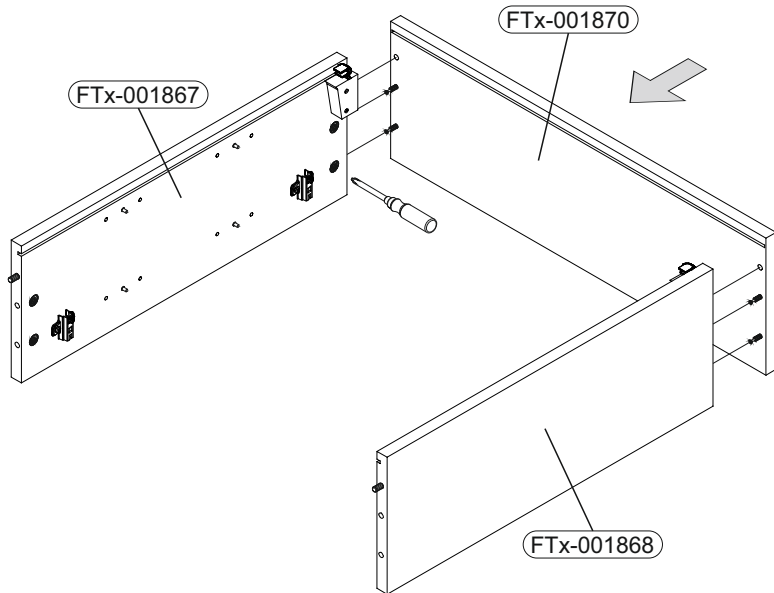
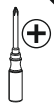

5



|         |  |        |        |
|---------|--|--------|--------|
| B05-185 |  | B01-90 |        |
| 4x      |  | 4x     | 3,5x20 |

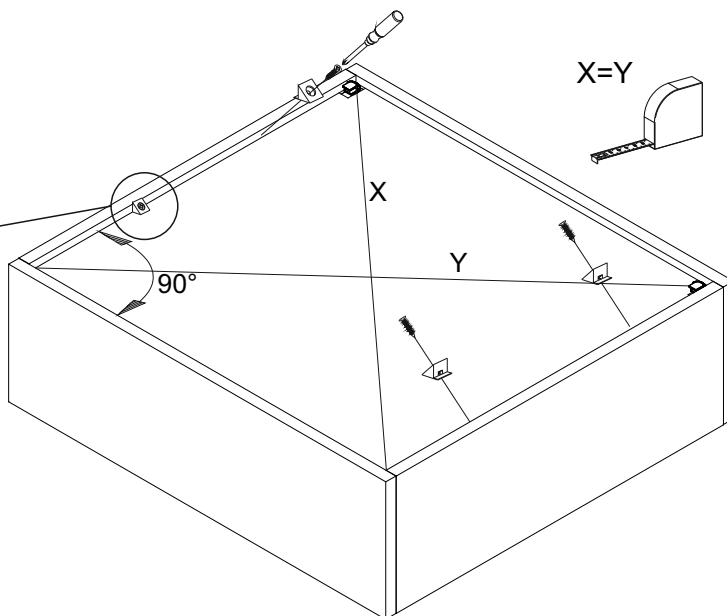
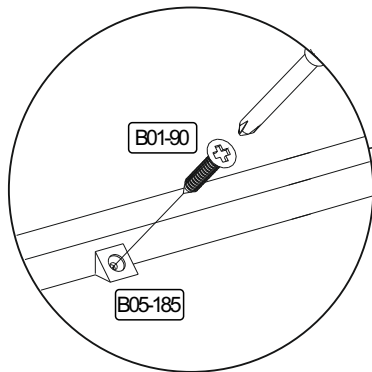
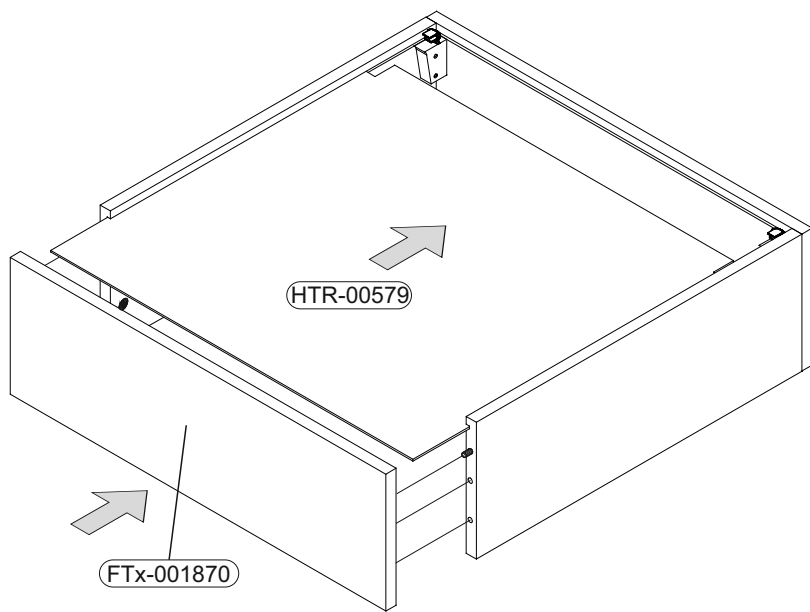

|          |        |        |         |        |       |
|----------|--------|--------|---------|--------|-------|
| <b>6</b> | B08-40 | B08-70 | B01-244 | B05-02 | ø20mm |
| +        | 2x     | 2x     | 1x      | 8x     |       |
|          | 5,8x65 | ø8mm   |         |        |       |

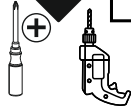

**1**

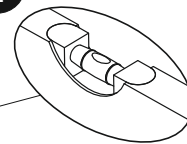

SCAN ME

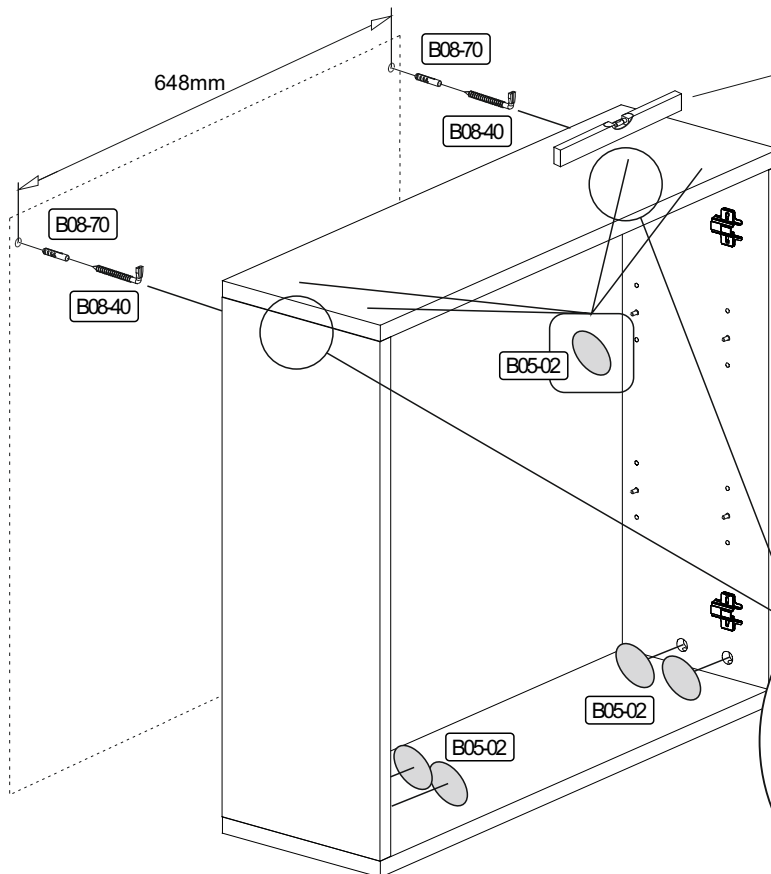
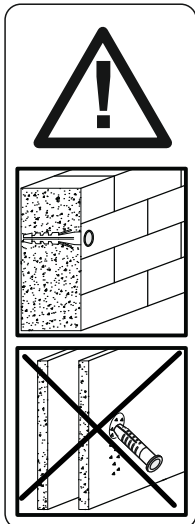

|        |       |
|--------|-------|
| B05-02 |       |
| 8x     | ø20mm |

**2**

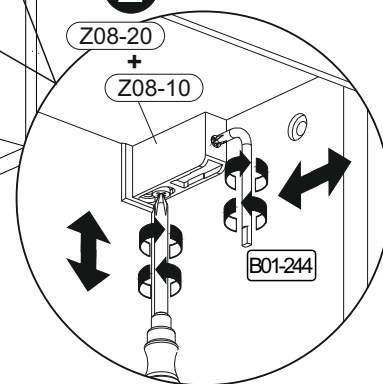

| <p><b>! Achtung • Attention • Attenzione • Opgelet • Uwaga • Pozor • Figyelem • Atenție • Dikkat • Внимание • Fara • Vaara • Fare • Peligro !</b></p> |   |
|---|---|
| <b>(D)</b>  | Wandbefestigung dient als Kippschutz - unbedingt anbringen! Bei einigen Wandtypen kann ein Spezialdübel erforderlich sein!  |
| <b>(GB)</b>   | The wall fastening serves to prevent tipping - be absolutely sure to mount it! For certain wall types, a special wall plug may be necessary!                                    |
| <b>(FR)</b>   | La fixation murale sert de protection contre le basculement – à installer impérativement ! Pour certains types de murs il faut des chevilles spéciales !                        |
| <b>(TR)</b>   | Duvardaki sabitleme, devrilmeye karşı bir emniyet tedbiridir ve mutlaka monte edilmelidir! Bazı duvar tiplerinde bunun için özel bir dübel gerekli olabilir!                    |
| <b>(IT)</b>   | Il fissaggio alla parete serve da protezione anti-ribaltamento – attaccarla assolutamente! Per alcune strutture di parete può essere necessario un tassello speciale!           |
| <b>(NL)</b>   | Bevestiging aan de muur dient als kantelbescherming – zeker en vast bevestigen! Bij enkele muurtypes is een speciale plug misschien vereist!                                    |
| <b>(RU)</b>   | Обязательно установите крепление на стене во избежание опрокидывания! Для некоторых типов стен может потребоваться специальный дюбель!  |
| <b>(CZ)</b>   | Montáž na stěnu slouží jako ochrana proti převrnutí – bezpodmínečně umístěte! U některých typů stěn může být zapotřebí speciální hmoždinka!                                     |
| <b>(HU)</b>   | A terméket a falhoz kel rögzíténi, különben az felborulhat! Egyes faltípusoknál speciális tiplit kell használni!  |
| <b>(RO)</b>   | Sistemul de fixare la perete servește ca protecție la răsturnare - de montat obligatoriu! Pentru unele tipuri de pereți este posibil să fie necesar un diblu special!           |
| <b>(PL)</b>   | Mocowanie do ściany jest jednocześnie zabezpieczeniem przed przewróceniem – koniecznie zamontować! Do niektórych rodzajów ścian koniecznie zastosować specjalne kołki mocujące. |
| <b>(SWE)</b>  | Väggmontering fungerar som anti-lutnings skydd - det är viktigt att fästa det! En speciell plugg kan behövas för vissa väggtyper!   |
| <b>(FIN)</b>  | Seinäkiinnitys toimii kaatumista estävänä suojana - se on ehdottomasti kiinnitettävä! Joihinkin seinätyypeihin voidaan tarvita erityistappi!                                    |
| <b>(NOR)</b>  | Veggmontering fungerer som anti-vippebeskyttelse - det er viktig å feste det! En spesiell dyvel kan være nødvendig for noen veggtyper!  |
| <b>(DAN)</b>  | Vægmontering fungerer som anti-vip beskyttelse - det er vigtigt at fastgøre det! En speciel dyvel kan være påkrævet til nogle vægtyper!   |
| <b>(SK)</b>   | Upevnenie na stenu slúži ako ochrana proti prevráteniu – bezpodmienečne použite! Pre niektoré druhy stien môže byť potrebná špeciálna hmoždinka!                                |
| <b>(ES)</b>   | El montaje en la pared sirve como protección antivuelco: ¡es imprescindible fijarlo! ¡Es posible que se requiera una espiga especial para algunos tipos de paredes!             |

7

|         |  |         |        |        |  |        |       |
|---------|--|---------|--------|--------|--|--------|-------|
| B06-425 |  | B01-200 |        | B03-07 |  | B05-02 |       |
| 2x      |  | 4x      | 6,3x13 | 2x     |  | 8x     | ø20mm |

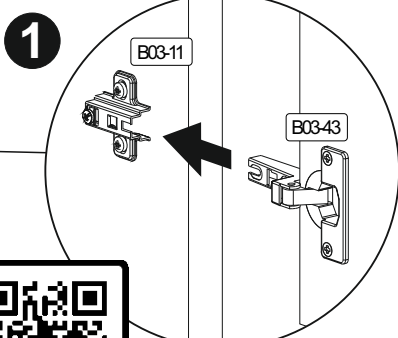
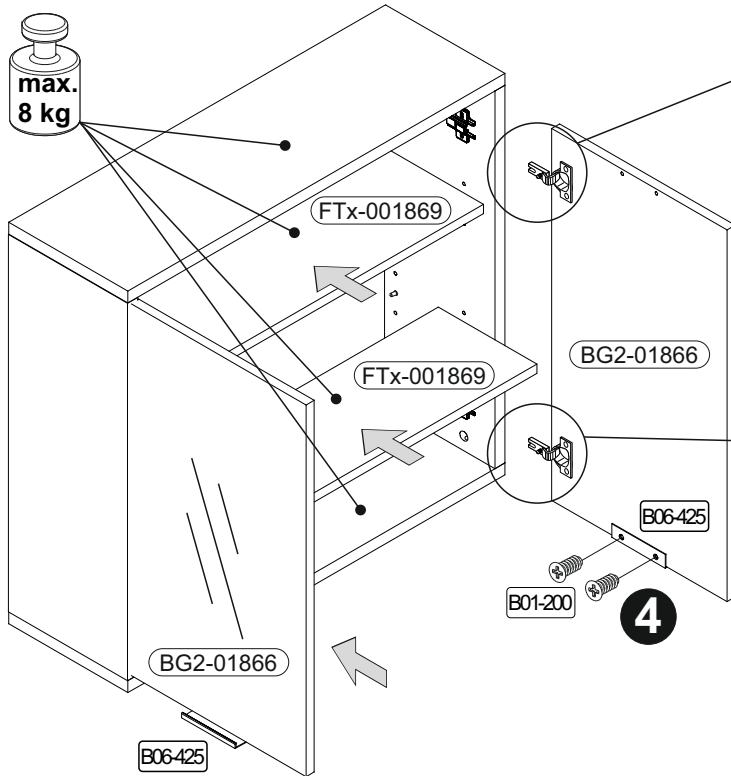
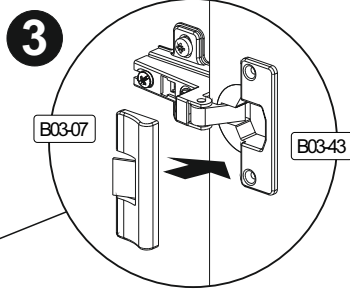
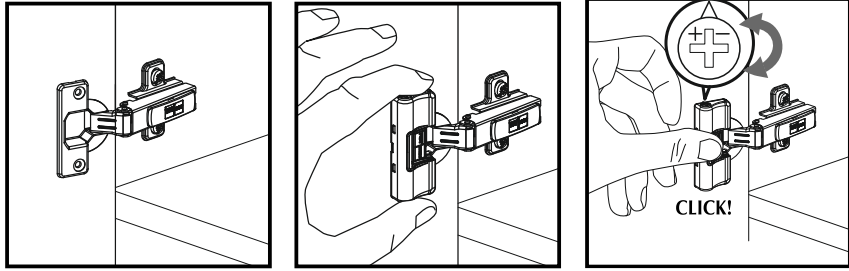

SCAN ME

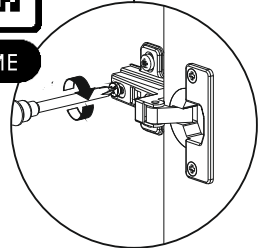

2



SCAN ME

